

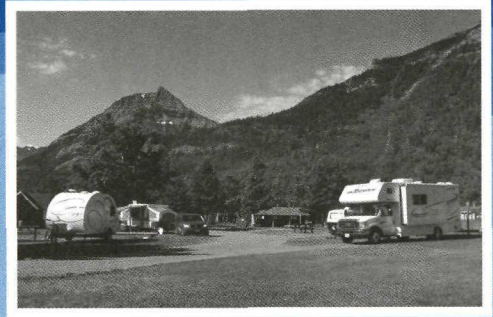

Welcome to Townsite CAMPGROUND



This sunny open campground offers 237 sites (94 of which are fully serviced pull-throughs, and 46 back-in electrical), hot showers, flush toilets, food storage and kitchen shelters. An excellent place for RVs or for those who wish to be within walking distance of Upper Waterton Lake, Cameron Falls and town amenities, the area is in high demand in July and August and on long weekends. Watch for strong winds and quickly changing weather.

In 1935, Townsite Campground saw 387 vehicles and 1700 people. Now the same numbers can be reached in a single weekend. With so much use, every visitor plays an important role in protecting the campground and the park.

Please contribute to the quiet, relaxed, natural experience campers come here to enjoy.

What you do affects wildlife and other campers' experience.



Bears and other wildlife live in the area and are attracted to food

odours. Place garbage in bins, and avoid cooking inside tents and tent trailers. All food supplies, including coolers, must be stored in your vehicles or in food storage lockers, located throughout the campground. Please keep a clean campsite; read the brochure entitled *The "Bare" Campsite Program*.



Pets may jeopardize your safety and theirs if they provoke or attract wildlife.

Some deer in town will attack without provocation, and can seriously injure or kill a dog. When you see a deer, immediately retreat from the area. Please report any incident to park staff.



For the safety of both pets and wildlife, pets must be leashed and never left unattended.

Please clean up after your pet and don't leave their food outside to attract wildlife.



Columbian ground squirrels, native to

Waterton, prefer areas with short, mowed grass. As such, their numbers in the campground are higher than normal. Increasing natural vegetation with less mowing, and with fenced areas, should reduce ground squirrel numbers to more natural levels.

When walking in the campground, watch your step around ground squirrel burrows and mounds, especially at night. Use a flashlight.



WATERTON TOWNSITE CAMPGROUND

TERRAIN DE CAMPING TOWNSITE

LEGEND LÉGENDE

- Information Resignements
- Washrooms Toilettes
- Showers Douches
- Accessible Accès universel
- Kitchen Shelter Abri de cuisine
- Trailer Sanitation Depot Fosse septique pour remorques
- Trails Sentier
- Interpretive Theatre Théâtre d'interprétation
- Food Storage Garde-manger
- Parking Stationnement
- Bike Trail Sentier pour bicyclette

WATERTON EMERGENCY CALLS

FOR ANY EMERGENCY CALL..... 911
 VISITOR INFORMATION..... 403-859-5133
 RCMP (MAY-OCT)..... 403-859-2244
 WARDENS..... 1-888-WARDENS (24 hrs)

NUMÉROS À COMPOSER EN CAS D'URGENCE

POUR TOUT APPEL D'URGENCE..... 911
 RENSEIGNEMENTS AUX VISITEURS . 403-859-5133
 GRD (MAY-OCT)..... 403-859-2244
 GARDES DU PARC..... 1-888-WARDENS (24 hrs)

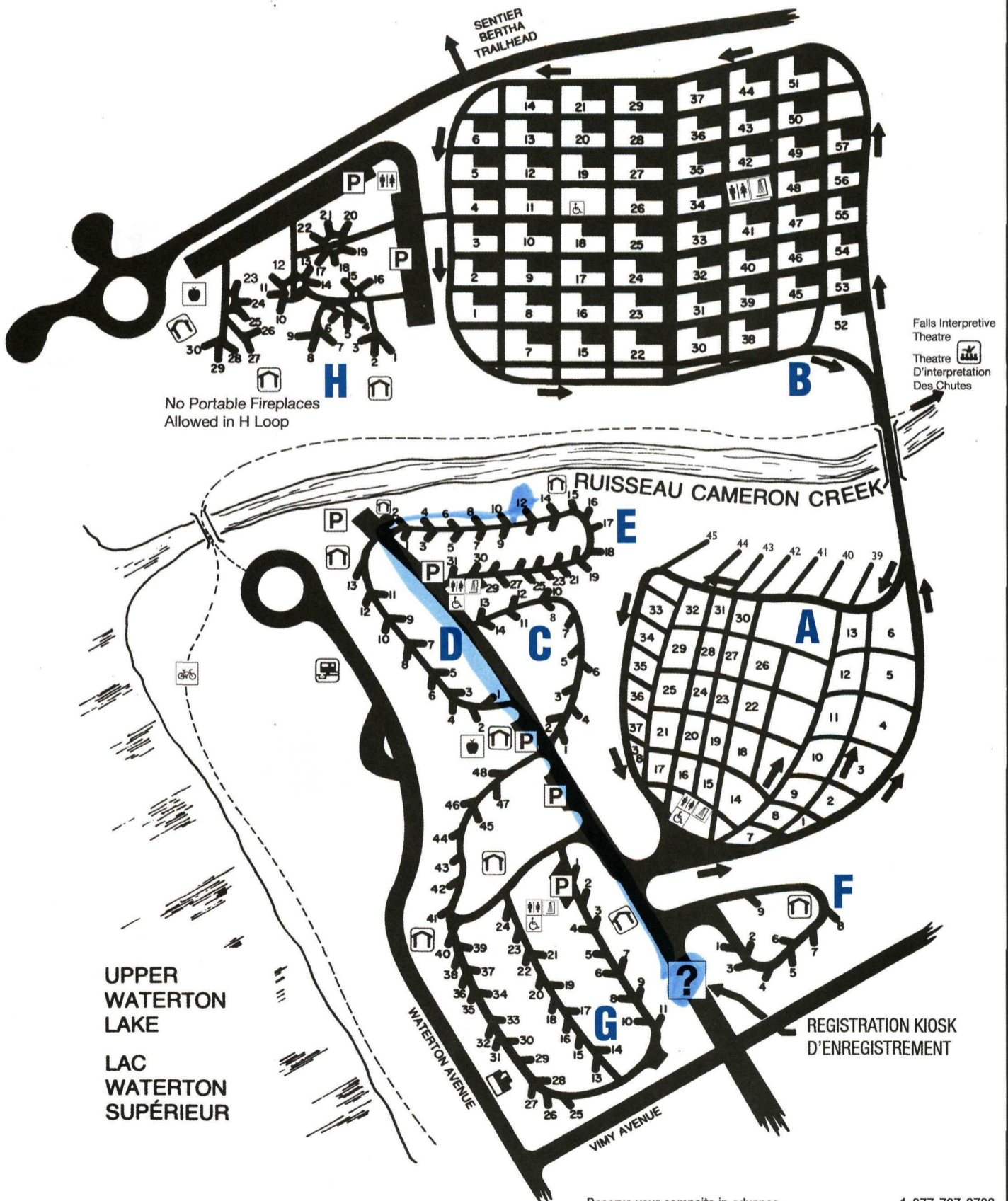

UPPER
WATERTON
LAKE
LAC
WATERTON
SUPÉRIEUR

Reserve your campsite in advance..... 1-877-737-3783
 Réservez votre emplacement de camping à l'avance... 1-877-737-3783
 To reserve online www.reservation.parkscanada.gc.ca
 Pour réserver en ligne www.reservation.parkscanada.gc.ca

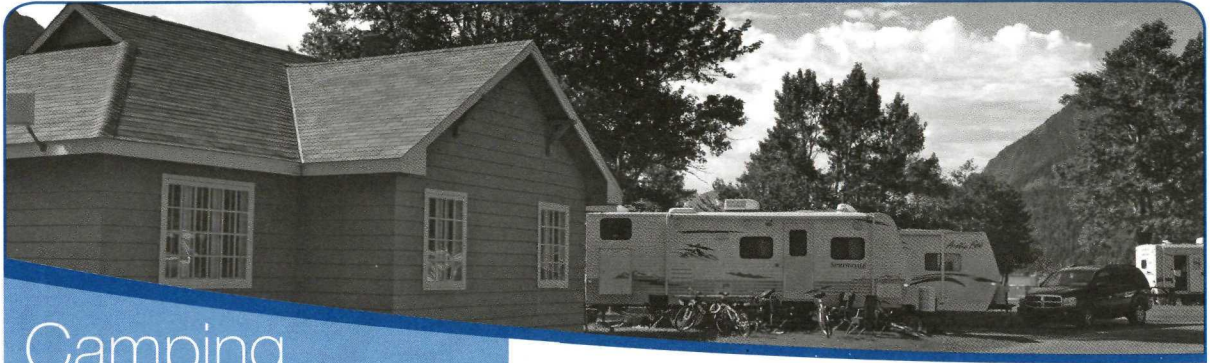

Camping Regulations

As the holder of a camping permit, you are responsible for the behaviour of all members of your group.

- **One non-transferable camping permit will be issued per campsite, per party (maximum 6 persons).** Campers must be here with their camping units to register. You need both a camping permit and park pass.
- **Each campsite may contain up to two camping units, as long as one is a tent.**
- Place your vehicle, motorhome, and/or trailer on the gravel or asphalt pad. All extra vehicles must be parked in the parking areas near washrooms. **Do not park on the grass.**
- **Share the common kitchen shelters** located throughout the campground. Never store food or equipment in these buildings; pets are not permitted in the shelters. Alcohol may be consumed on your campsite only. Refrain from using kitchen shelters during quiet hours (10:00 pm - 7:00 am).
- **Propane-fuelled portable fireplaces** are allowed if placed on a non-combustible surface, away from flammable objects. **Do not place on picnic tables, and extinguish when windy. Do not leave unattended.**
- **No portable fireplaces in H Loop**
- **Wood burning portable fireplaces are prohibited.**
- **Checkout** or re-registration time is 11:00 AM. Maximum length of stay is 14 nights.
- **Quiet hours** are from 10:00 PM to 7:00 AM.
- **Generator use** is limited to: 7:00 AM-9:00 AM, 11:00 AM-1:00 PM & 5:00 PM-7:00 PM.
- No visitors after 10:00 PM.
- **Loud partying and rowdiness are not permitted at any time.**
- Display your camping and park permit in a visible location such as the dashboard of your vehicle. Notify the attendant if you plan to be absent for more than 24 hours.
- **Fires** are permitted only in designated stoves in the picnic shelters. Cutting live or dead standing trees and gathering deadfall is not allowed.
- Deposit your camping permit in the box at the kiosk when checking out of the campground.

Good to Know

All sites at Townsite Campground are reservable. High demand sites and times may require a reservation. Reserve on-line at www.reservation.parkscanada.gc.ca or call 1-877-737-3783.

For more information about Waterton Lakes National Park, **stop by the Visitor Centre** (summer months), go online at www.parkscanada.gc.ca/waterton or call 403-859-5133.

Available nearby:

